

KITCHEN FILE

Design

Su Lupasco Washington with Paul Newman at Paul Newman Interiors, 136 High Street, Hadleigh, Essex SS7 2PB (01702 552868)

Worksurfaces

Ruby Corian, approx £400 per sq m; 30mm Verde Amadeus granite, approx £300 per sq m; Antique Gold marble, approx £500 per sq m

Flooring

Corkmaster in Olive, £36.10 per sq m, Amorim Flooring UK

Appliances

Q900GRF built-in double oven, £1150, Stoves; T2333 hob, £302, Neff; KD 9800.0 canopy, £1750, MW900 microwave, £440, integrated fridge freezer, £985, all Küppersbusch

Sink and tap

Sink, integral part of island worksurface, Corian; 35800 Allegra tap, £338, Hansgrohe

PRICE GUIDE

Approx £10,000

Starting price for an Aho kitchen, excluding appliances

KITCHEN LAYOUT

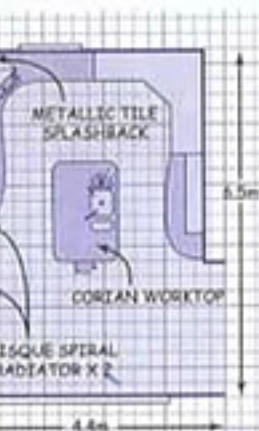

THE ART OF LIVING

Using some unusual decorating techniques, Su Lupasco Washington has turned her kitchen into a real work of art



So chose Bella Linea units from Aino in Vanilla because of their simple, curvy lines. They are complemented by kickplates in stainless steel while soft olive cork floor tiles help to give the room warmth



1 The sink, with its integral drainer, is moulded out of Ruby Corian creating a strong and seamless appearance



2

Using her experience in working with metal, Su was able to create a stunning frame for the tiles in the marble-topped display area. Two Bisque Spring radiators frame it on either side. The pottery vase is one of many pieces of her late husband Bob's work in the room

3 Metalwork in the room is shown at its best on glass shelves in front of tiles from Fired Earth's Glass Art range

4 Set into the corner of the room, with a background of Metallic tiles from Fired Earth, is a brushed steel hob from Neff. Su made the mosaic framing the window using a selection of broken pieces of tiles

5 Su didn't want cupboard doors opening out into the room so these bi-fold ones in opaque glass and aluminium were a perfect alternative. The Saturn, Mars and Jupiter tiles came from Fired Earth's Planets collection



4

FEATURE HANNAH GRASS. PHOTOGRAPHY ANDREW DEE

For artist Su Lupasco Washington, relocating her ageing kitchen from a room at the side of her property to an inspiring living area that overlooks rolling orchards and fields was a real labour of love. Her new kitchen was to be created from an existing living area and would form an appropriate backdrop for the work of Su's late husband, artist RJ Washington. 'Bob's work has inspired me greatly and a big part of my life is spent promoting his work. The choice to move the kitchen to a central part of the house is all part of that,' explains Su.

Su, who shares the house with her nine-year-old daughter Olivia, spent a lot of time looking at the shape of the room once it had been cleared. She then

went in search of a kitchen and, after some failed attempts, a friend suggested Alno. 'I was really keen to have curved edges on the corners of the units and lots of different types of materials in the room and Alno had a lot of these features in its range,' says Su.

Su made preliminary sketches before employing Paul Newman Interiors to draw up final plans and supply the Alno Bella Linea units in vanilla, chosen by Su for their simple lines and curves. In particular, she liked the wall units, which had practical bi-fold doors and the pull out larder units that were fitted with shelving and storage containers.

The transformation of the kitchen was in full swing so, while appliances were being installed, Su took time



5



'I wanted to use lots of different materials'

6 Su is delighted with her Küppersbusch appliances including this glass and stainless-steel hood. 'I felt that it was the right choice for such a contemporary room'

7 The two soap dispensers on the Ruby Corian worksurface, one in ceramic and one in steel, both came from Ocean



out to shop around for wall tiles for three different zones. With her background in ceramics, she was keen for this element of the room to be quite eye-catching. 'I chose groups of tiles from different ranges and also picked out some materials for a mosaic piece as well.'

Although the tiling in the room was looking fantastic; behind the hob was a particular focal point, Su wanted another outstanding feature and was keen to use metal. Two Spring radiators from Bisque presented the answer. Su used them to flank the display shelves that were fitted in front of the glass tiled backdrop and then framed the area with brushed steel and bronze, which once annealed (a toughening process), looked burnished.

The final touches by the windows were also made by Su. Using pieces of ceramic and other materials she created a 'mosaic curtain' framing one window, while a friend used a Fired Earth fabric to make a blind for another. The completed room looks stunning and Su can now sit back and enjoy the fruits of her labour. ☺

Where to buy

Also 020 6698 4781 **Amorim Flooring UK** 01403 710001
Bisque 020 7328 2225 **Corian** 0800 962116 **Fired Earth**
 01295 812088 **Franke** 0161 436 6280 **Hansgrohe**
 01372 465655 **Küppersbusch** 01235 621289 **Neff** 0870
 513 3090 **Ocean** 0870 242 6283 **Stoves** 0151 428 6551